



Prosurge SPV series is a Type 1CA SPD according to UL 1449 4th, designed for Photovoltaic system DC-side protection against the damage from surges caused by lightning and other electrical sources.

Rating:

- **Max. permitted DC voltage (Vpvc): 85V~1500Vdc**
- **Surge capacity (8/20µs): 50kA**
- **Short circuit current rating (SCCR): 100kArms - tested without external CB or fuse**

Technical Features:

- UL recognized Type 1CA SPD (ANSI/UL1449 4th), Type 2CA SPD (CSA-C22.2) for PV/ Photovoltaic system. (UL File No. E319871).
- Pluggable design with window fault indication
- Remote alarm signal optional
- Meet worldwide standards of UL 1449-4th, IEC 61643-31:2018 & EN50539-11:2013
- Global patented thermal disconnecter design with arc extinguishing device, fail-safe & self-protected, quick thermal response and perfect circuit cutoff function. No additional over-current protection devices required.



Single mode or I Configuration protection

Part No.		Pole	Nominal Voltage (Vdc)	Max. Permitted DC Voltage, Vpvc (V)	Nominal Discharge Current, In (8/20µs) (kA)	Max. Discharge Current, Imax (8/20µs) (kA)	Voltage Protection Rating, VPR (kV)	SCCR Rating (kArms)
Type 1ca	Type 2ca							
SPV48-V-S	SPV48-V-S/C	1	48	85	20	50	0.4	30
SPV500-V-S	SPV500-V-S/C	1	500	560	20	50	1.5	100
SPV600-V-S	SPV600-V-S/C	1	600	670	20	50	1.5	50

• Dimension drawing

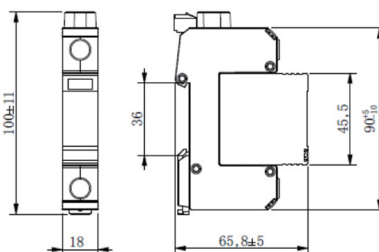

• Basic circuit diagram

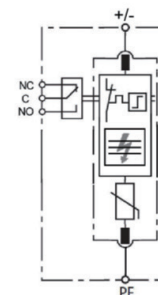

V Configuration protection

Part No.		Pole	Nominal Voltage (Vdc)	Max. Permitted DC Voltage, Vpvc (V)	Nominal Discharge Current, In (8/20µs) (kA)	Max. Discharge Current, Imax (8/20µs) (kA)	Voltage Protection Rating, VPR (kV)	SCCR Rating (kArms)
Type 1ca	Type 2ca							
SPV48-V-C-S	SPV48-V-C-S/C	2	48	85	20	50	0.4	30
SPV500-V-C-S	SPV500-V-C-S/C	2	500	560	20	50	1.5	100
SPV600-V-C-S	SPV600-V-C-S/C	2	600	670	20	50	1.5	50

• Dimension drawing

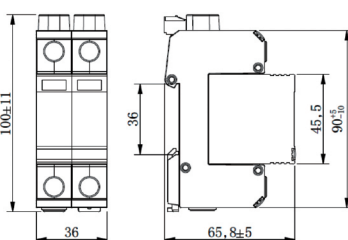

• Basic circuit diagram

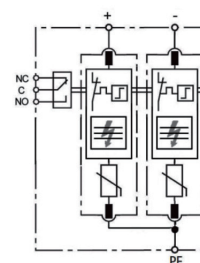



Y Configuration protection

Part No.		Pole	Nominal Voltage (Vdc)	Max. Permitted DC Voltage, Vpvc (V)	Nominal Discharge Current, In (8/20µs) (kA)	Max. Discharge Current, Imax (8/20µs) (kA)	Voltage Protection Rating, VPR (kV)	SCCR Rating (kArms)
Type 1ca	Type 2ca							
SPV600-V-CD-S	SPV600-V-CD-S/C	3	600	700	20	50	1.8	50
SPV800-V-CD-S	SPV800-V-CD-S/C	3	800	920	20	50	2.5	50
SPV1000-V-CD-S	SPV1000-V-CD-S/C	3	1000	1120	20	50	2.5	50
SPV1200-V-CD-S	SPV1200-V-CD-S/C	3	1200	1340	20	50	3.0	50
SPV1500-V-CD-S	SPV1500-V-CD-S/C	3	1500	1500	20	50	4.0	50

- Dimension drawing

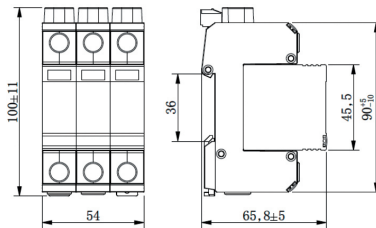

- Basic circuit diagram

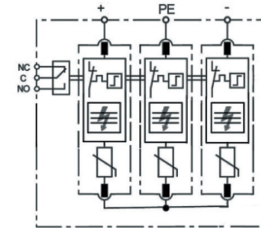

2Y Configuration protection

Part No.		Pole	Nominal Voltage (Vdc)	Max. Permitted DC Voltage, Vpvc (V)	Nominal Discharge Current, In (8/20µs) (kA)	Max. Discharge Current, Imax (8/20µs) (kA)	Voltage Protection Rating, VPR (kV)	SCCR Rating (kArms)
Type 1ca	Type 2ca							
SPV600-V-CD2-S	SPV600-V-CD2-S/C	3	600	700	20	50	1.8	50
SPV800-V-CD2-S	SPV800-V-CD2-S/C	3	800	920	20	50	2.5	50
SPV1000-V-CD2-S	SPV1000-V-CD2-S/C	3	1000	1120	20	50	2.5	50
SPV1200-V-CD2-S	SPV1200-V-CD2-S/C	3	1200	1340	20	50	3.0	50
SPV1500-V-CD2-S	SPV1500-V-CD2-S/C	3	1500	1500	20	50	4.0	50

- Dimension drawing

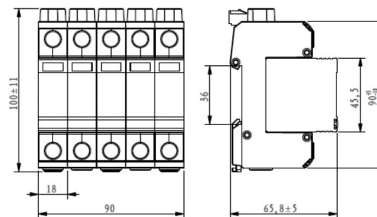

- Basic circuit diagram

